

SUBMITTAL

Duct Humidity Transducer

Part Number:

PRODUCT SELECTION INFORMATION:

MODEL	Product Description
RH210A	Duct Humidity/Temperature Transducer

CODE	Accuracy
02	2%
03	3%
05	5%

CODE	Accuracy
C	PT1000-1000Ω Platinum, IEC 751, 385 Alpha, thin film
L	PT100-100Ω Platinum, IEC 751, 385 Alpha, thin film

CODE	Output/Supply Voltage (RH and Temperature)
2A	4-20mA, 24 Vac/dc
2D	0-5 Vdc, 24 Vac/dc
2E	0-10 Vdc, 24 Vac/dc

CODE	Options
1	0° - 35°C (32° - 95°F)
2	0° - 50°C (32° - 122°F)
3	0° - 100°C (32° - 212°F)
6	-50° - 50°C (-58° - 122°F)

RH210A 02 C 2A 2

Greystone Energy Systems, Inc. reserves the right to make design modifications without prior notice.

EXAMPLE: Duct humidity/temperature, 2%, 0-50°C, 4-20mA

The RH110A series uses a highly accurate and reliable Thermoset Polymer based capacitance humidity sensor and Platinum RTD temperature sensor together with state-of-the-art digital linearization and temperature compensated circuitry to monitor humidity levels. The sensors are encapsulated in a 9" (228.60 mm) long by 0.5" (12.7 mm) diameter 304 S/S probe. A 60 micron HDPE filter protects the sensor for contaminants.

RH Sensor Type	Thermoset Polymer based capacitive
RH Range	0 to 100% RH
RH Accuracy	±2, 3, or 5% (5 to 95%)
RH Response	15 Seconds typical
RH Stability	±1% RH typical @ 50% RH in 5 years
Temp. Sensor	PT1000-1000Ω Platinum, IEC 751, 385 Alpha, thin film PT100-100Ω Platinum, IEC 751, 385 Alpha, thin film
Temp. Accuracy	±0.1% of span, including linearity
PCB Operating Temperature	0 to 50 °C (32 to 122 °F)
Power Supply	18 to 35 Vdc, 15 to 26 Vac
Output Signal	4-20 mA current loop 0-5, or 0-10 Vdc
Consumption	22 mA maximum
Enclosure	ABS - UL94V - Nema 1 (IP23)
Probe	304 series stainless steel w/ 60 micron HDPE filter
Wiring Connections	Screw Terminal Block (14 to 22 AWG)

Installation:

The duct type probes are installed through a hole in the side of the duct to monitor a single point humidity within the duct. Install the probe in a straight section of duct at a suitable distance downstream from any heating, cooling or humidification devices.

Each enclosure style provides mounting tabs on the outside of the enclosure for ease of installation .

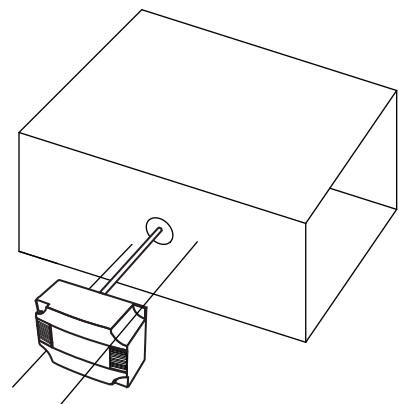
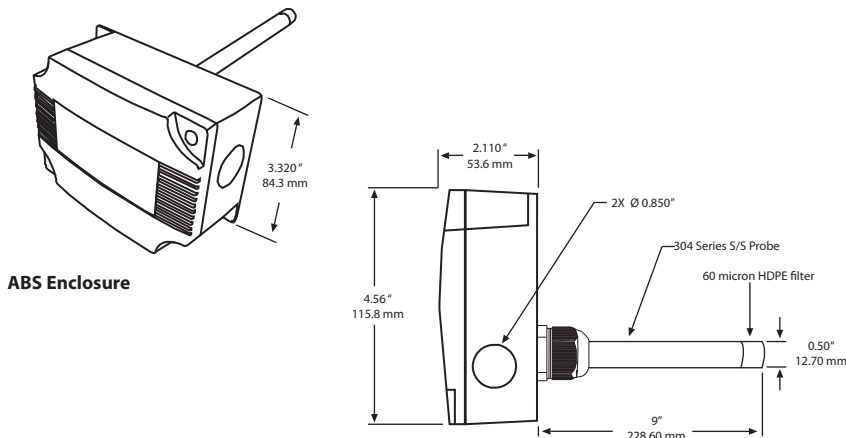

GREYSTONE
ACCURACY BY DESIGN

Greystone Energy Systems, Inc.
150 English Drive, Moncton, NB
Canada E1E 4G7

(506) 853-3057 Fax: (506) 853-6014
North America: 1-800-561-5611
e-mail: mail@greystoneenergy.com
www.greystoneenergy.com

RoHS
COMPLIANT

